

LF-300 Datasheet

LOW-FLOW PRESSURE REGULATOR



● Gas ● Liquid | ● Diaphragm ● Piston | ● Self-Venting ● Non-Venting | Max Inlet: 300bar (4,350psi) | Max Outlet: 35bar (510psi) | Cv 0.06



INTRODUCING THE LF-300...

The LF-300 is a single-stage diaphragm-sensed pressure regulator with a cone seat design. Its strong Inconel® X750 diaphragm lasts 50% longer than typical stainless steel designs and offers high accuracy.

A brass machined washer also ensures no torsional load is applied to the diaphragm during assembly.

Lightweight and compact the LF-300 is perfect for customers looking for a regulator with a small footprint.

SPECIFICATION

Max Rated Inlet Pressure	300bar (4,350psi)
Outlet Ranges	Up to 35bar (510psi)
Design Proof Pressure	150% max WP
Seat Leakage	In accordance with ANSI/FCI 70-3
Weight	0.9kg (2lbs)

STANDARD MATERIALS OF CONSTRUCTION

Other materials are available - please contact the office.

PART	MATERIALS
Body and Bonnet	AISI 316 / 316L Stainless Steel (UNS S31600 / S31603)
Main Valve Pin	AISI 316 / 316L Stainless Steel (UNS S31600 / S31603)
Soft Seat	PEEK™ or PCTFE
Valve Spring	Inconel® X750
Diaphragm	Inconel® X750
Handwheel	Nylon
'O'-Ring Seals	FKM / FPM
Loading Spring	AISI 302 Stainless Steel (UNS S30200)

FEATURES AND BENEFITS

1 INCONEL® X750 DIAPHRAGM

For ultimate strength and reliability on clean or corrosive applications.

2 316SS THREADED BONNET

For panel mounting option as standard.

3 WIDE RANGE OF SEAT MATERIALS

Covers a wide range of applications.

4 40 MICRON INLET FILTER

First stage soft seat protection from system contamination.

NOTE: Product availability and specifications contained herein are subject to change without notice. Consult local distributor or factory for potential revisions and/or service related issues. Pressure Tech Ltd support with product selection recommendations only - it is the users responsibility to ensure the product is suitable for their specific application requirements.



DESIGNED AND BUILT IN THE UK

PRESSURE TECH LTD

Unit 24, Graphite Way, Hadfield, Glossop, Derbyshire, UK, SK13 1QH
T +44 (0)1457 899 307
E info@pressure-tech.com
W www.pressure-tech.com

140717

PAGE:
1 OF 4

LF-300 Datasheet

LOW-FLOW PRESSURE REGULATOR



Gas Liquid | Diaphragm Piston | Self-Venting Non-Venting | Max Inlet: 300bar (4,350psi) | Max Outlet: 35bar (510psi) | Cv 0.06

DRAWINGS AND INSTALLATION DIMENSIONS

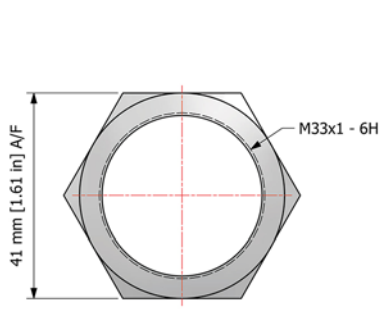
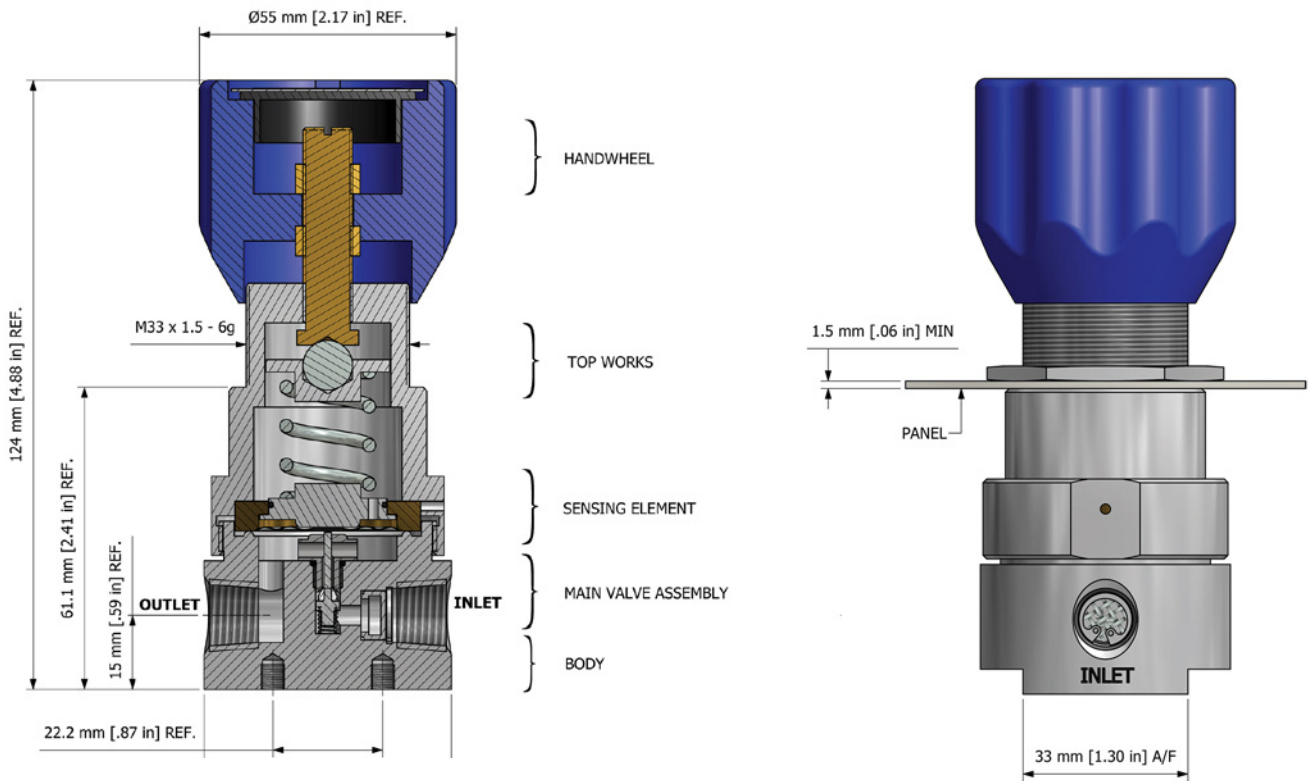

PT-C-024
STAINLESS STEEL
PANEL MOUNT RING

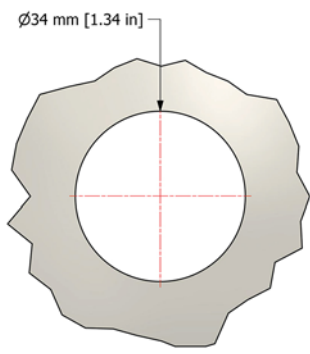

PANEL CUT OUT

Note:
All gauge ports are 1/4" NPT as standard.

NOTE: Product availability and specifications contained herein are subject to change without notice. Consult local distributor or factory for potential revisions and/or service related issues. Pressure Tech Ltd support with product selection recommendations only - it is the users responsibility to ensure the product is suitable for their specific application requirements.



DESIGNED AND BUILT IN THE UK

PRESSURE TECH LTD
Unit 24, Graphite Way, Hadfield, Glossop, Derbyshire, UK, SK13 1QH
T +44 (0)1457 899 307
E info@pressure-tech.com
W www.pressure-tech.com

140717

PAGE:
2 OF 4

LF-300 Datasheet

LOW-FLOW PRESSURE REGULATOR



Gas
 Liquid
 |
 Diaphragm
 Piston
 |
 Self-Venting
 Non-Venting
 |
 Max Inlet: 300bar (4,350psi)
 |
 Max Outlet: 35bar (510psi)
 |
 Cv 0.06

FLOW CURVE

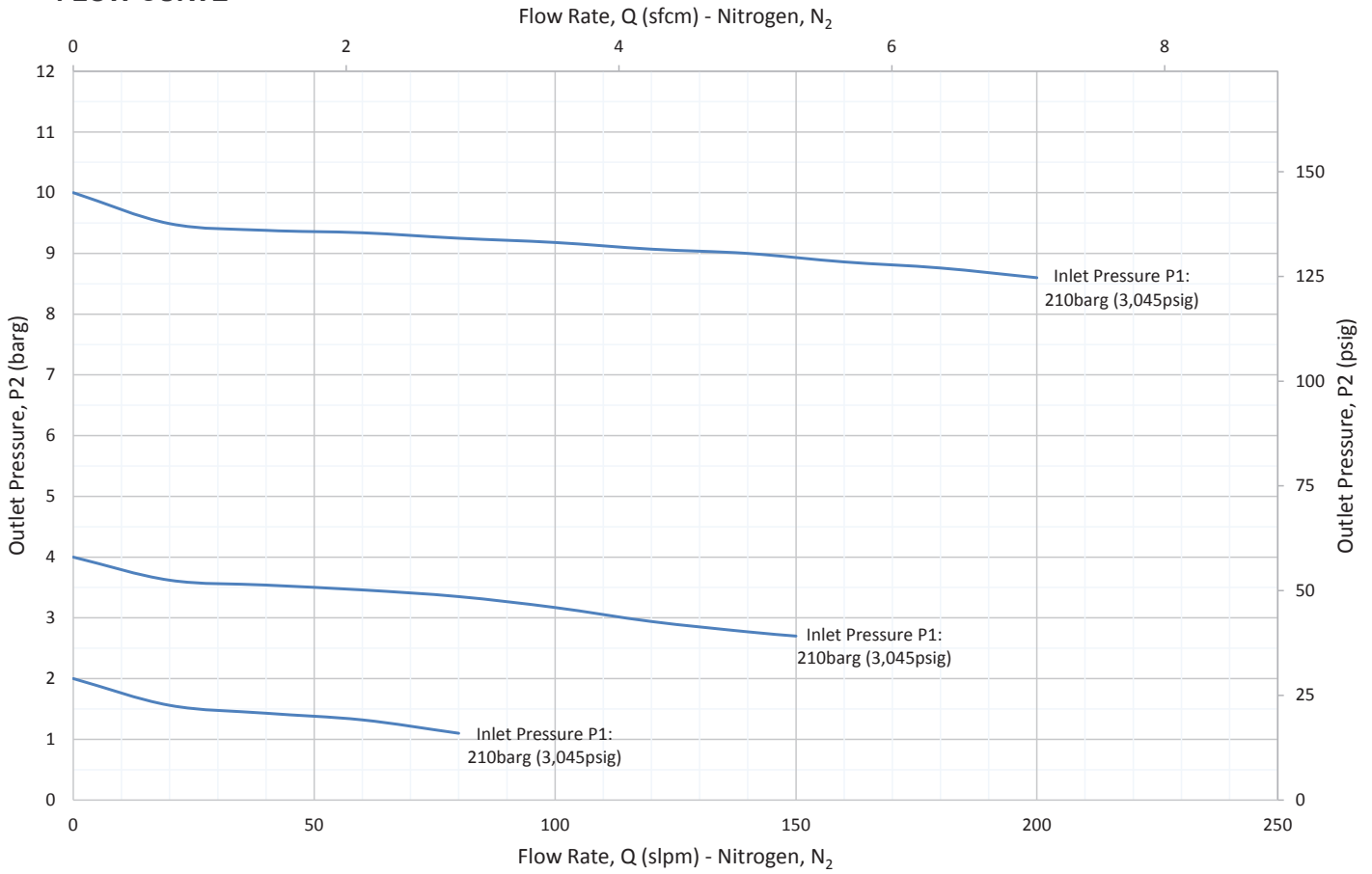

PORTING CONFIGURATIONS

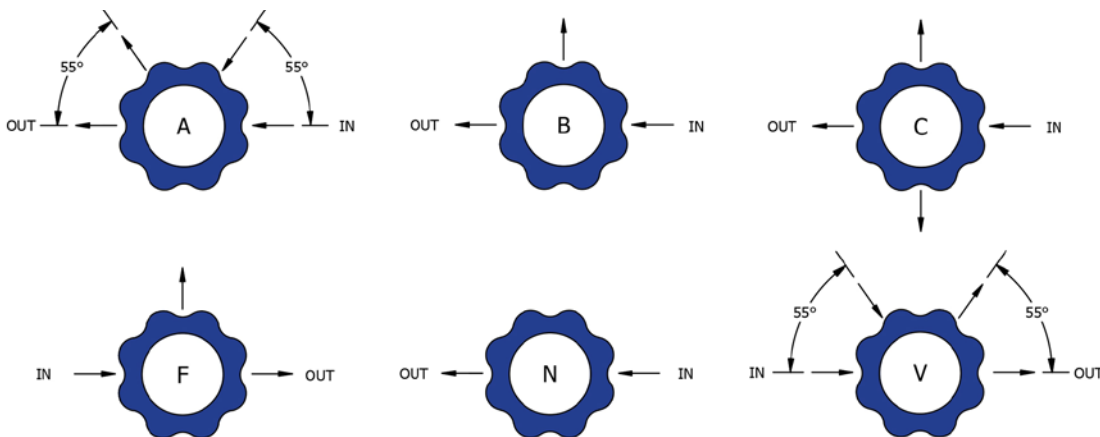

Note:

Additional porting configurations are available - please contact the office for further information.

NOTE: Product availability and specifications contained herein are subject to change without notice. Consult local distributor or factory for potential revisions and/or service related issues. Pressure Tech Ltd support with product selection recommendations only - it is the users responsibility to ensure the product is suitable for their specific application requirements.



DESIGNED AND BUILT IN THE UK

PRESSURE TECH LTD

Unit 24, Graphite Way, Hadfield, Glossop, Derbyshire, UK, SK13 1QH
 T +44 (0)1457 899 307
 E info@pressure-tech.com
 W www.pressure-tech.com

140717

PAGE:
3 OF 4

LF-300 Datasheet

LOW-FLOW PRESSURE REGULATOR



Gas
 Liquid
 |
 Diaphragm
 Piston
 |
 Self-Venting
 Non-Venting
 |
 Max Inlet: 300bar (4,350psi)
 |
 Max Outlet: 35bar (510psi)
 |
 Cv 0.06

ORDERING INFORMATION

To build a Pressure Tech part number, simply combine the characters identified below in sequence:

LF300 - 06 - S - 35 - P - N - XXX	
REGULATOR MODEL/SERIES LF300 – Single-Stage Pressure Regulator - Diaphragm-Sensed	MODIFICATIONS* Please contact the office for further information.
CV VALUE 03 – 0.03 06 – 0.06 15 – 0.15	PORTING CONFIGURATION N - No gauge ports Please refer to page 3 for porting configuration options.
BODY MATERIAL S – AISI 316 / 316L Stainless Steel (UNS S31600 / S31603) B – HT Brass H – Hastelloy® (UNS N10276)	SEAT MATERIAL T – PTFE (20bar / 290psi inlet) F – FEP (50bar / 725psi inlet) K – PCTFE (210bar / 3045psi inlet) P – PEEK™ (300bar / 4350psi inlet)
CONTROL PRESSURE 05 – 0 to 5bar (0 to 75psi) 10 – 0 to 10bar (0 to 145psi) 20 – 0 to 20bar (0 to 290psi) 35 – 0 to 35bar (0 to 510psi)	* Where applicable

OPTIONAL EXTRAS		
	PART NUMBER	DESCRIPTION
Service Kit	SRK-LF300-06-U-K-M2-V	PCTFE seat and FKM/FPM seals.
Service Kit	SRK-LF300-06-U-P-M2-V	PEEK™ seat and FKM/FPM seals.
Panel Mounting Ring	PT-C-024	

Note: Ancillary Equipment and additional Service Kit options also available. Please contact the office for further information.

TRADEMARKS: PEEK™ is a trademark of Victrex PLC
 Inconel® is a registered trademark of Inco Alloys International
 Hastelloy® is a registered trademark of Haynes International, Inc

NOTE: Product availability and specifications contained herein are subject to change without notice. Consult local distributor or factory for potential revisions and/or service related issues.
 Pressure Tech Ltd support with product selection recommendations only - it is the users responsibility to ensure the product is suitable for their specific application requirements.



DESIGNED AND BUILT IN THE UK

PRESSURE TECH LTD
 Unit 24, Graphite Way, Hadfield, Glossop, Derbyshire, UK, SK13 1QH
 T +44 (0)1457 899 307
 E info@pressure-tech.com
 W www.pressure-tech.com

140717

PAGE: 4 OF 4