

LF-301 SERIES

'Low Flow' Pressure Reducing Regulator // Piston Sensed for outlet control to 180bar / 2600psi

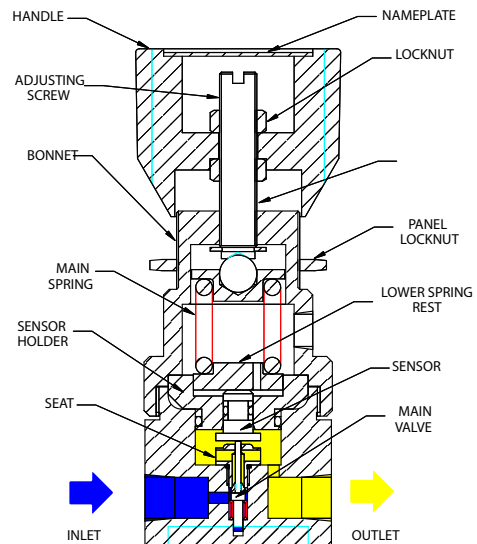

*Assembly drawing for reference only. Refer to office for specific detail.

The LF-301 provides a compact and economical solution for controlling pressures up to 180bar on low flow applications. Ideal for first stage pressure let down where basic pressure control is required. A small piston sensing element allows low torque adjustment with a range of springs with fine pressure adjustment.

APPLICATIONS:

- Gas Cylinder regulator assemblies
- Pressure test rigs
- Instrument Air Lines
- Aircraft service carts

FEATURES:

Compact design
Economical
316SS Bonnet
Max 300bar inlet

STANDARD MATERIALS OF CONSTRUCTION

Regulator part	Material
Body and Bonnet	316SS
Main valve pin	316SS
Soft seat cone	PEEK – Max 300bar PCTFE – Max 210bar
Valve spring	Inconel X750
Sensor and holder	316SS
Handwheel	Nylon
Spring rests	316SS
'O' ring seals	Viton
Adjusting screw	Alu Bronze
Loading Spring	302SS
Lubricant	Krytox GPL 205

NOTE: Product availability and specifications contained herein are subject to change without notice. Consult local distributor or factory for potential revisions and/or service related issues. // pg 1 of 2

PRESSURE TECH LTD, Unit 6, Graphite Way, Hadfield, Glossop, Derbyshire SK13 1QG
Tel: +44 (0)1457 899307 Fax: +44 (0)1457 899308
e-mail: info@pressure-tech.com

www.pressure-tech.com



Designed and built in the UK



LF-301 SERIES

'Low Flow' Pressure Reducing Regulator // Piston Sensed for outlet control to 180bar / 2600psi

INSTALLATION DIMENSIONS:

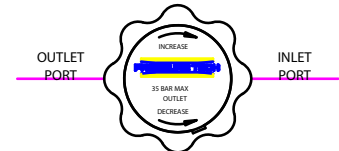
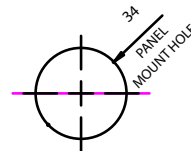
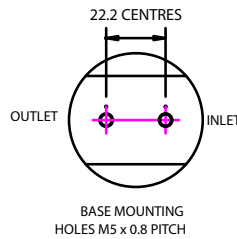
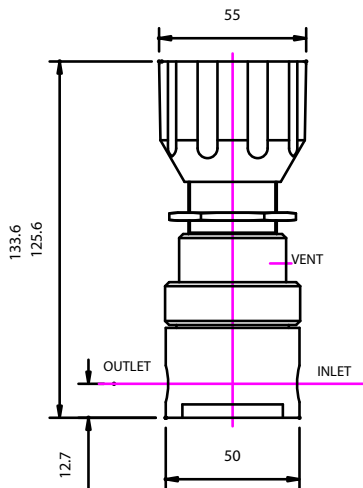

SPECIFICATION :

Max rated inlet pressure ..300bar (4350psi) with PEEK seat
 Outlet ranges 0 – 50, 0 – 100, 0 – 180bar
 Design Proof pressure 150% max WP
 Leakage Bubble tight at max WP (tested on Nitrogen)
 Weight 1kg (2.2lbs)

ORDERING INFORMATION:

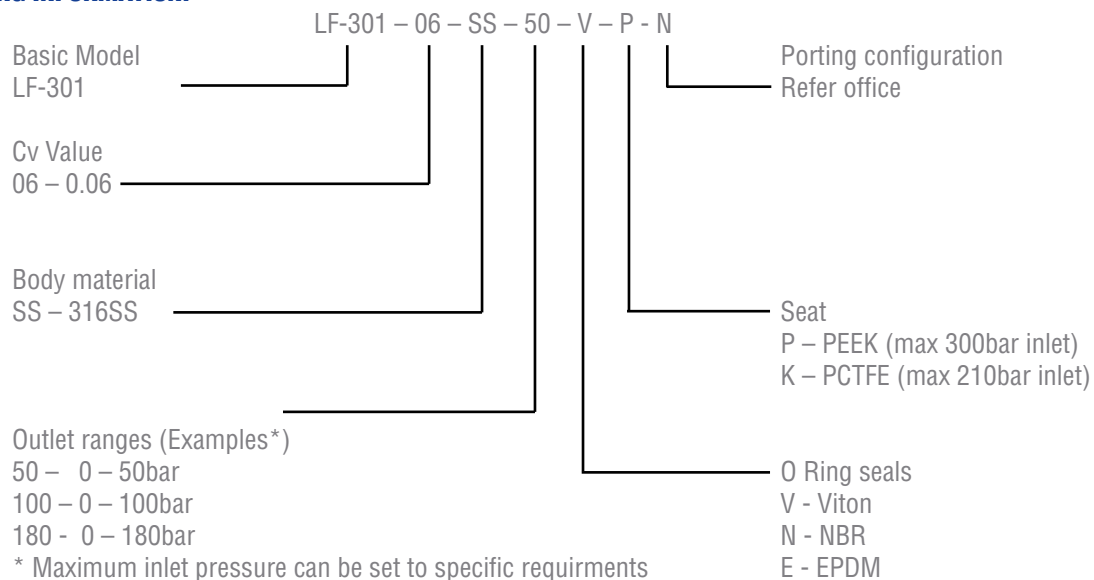

Panel Mounting Ring: PT-C-024

NOTE: Product availability and specifications contained herein are subject to change without notice. Consult local distributor or factory for potential revisions and/or service related issues. // pg 2 of 2