

MF-101 Datasheet

MEDIUM-FLOW PRESSURE REGULATOR



Gas
 Liquid
 |
 Diaphragm
 Piston
 |
 Self-Venting
 Non-Venting
 |
 Max Inlet: 414bar (6,000psi)
 |
 Max Outlet: 35bar (510psi)
 |
 Cv 0.5



INTRODUCING THE MF-101...

The MF-101 is a piston-sensed medium-flow pressure regulator. As standard the MF-101 features an unbalanced main valve with a large precision machined sensing element that controls outlet pressures up to 35bar (510psi) on self-venting models, and up to 40bar (580psi) on non-venting models from a maximum 100bar (1,450psi) inlet pressure.

Alternatively, its optional balanced design with PEEK™ seat enables inlet pressures of up to 414bar (6,000psi) on gas or liquid applications.

SPECIFICATION

Max Inlet Pressure:	Balanced	Unbalanced
PEEK™	414bar (6,000psi)	100bar (1,450psi)
PCTFE	300bar (4,350psi)	100bar (1,450psi)

STANDARD MATERIALS OF CONSTRUCTION

Other materials are available - please refer to page 4.

PART	MATERIALS
Body and Bonnet	AISI 316 / 316L Stainless Steel (UNS S31600 / S31603)
Main Valve Pin	AISI 316 / 316L Stainless Steel (UNS S31600 / S31603)
Soft Seat	PEEK™ or PCTFE
Valve Spring	Inconel® X750
Handwheel	Nylon
'O'-Ring Seals	FKM / FPM
Loading Spring	AISI 302 Stainless Steel (UNS S30200)
Piston	AISI 316 / 316L Stainless Steel (UNS S31600 / S31603)

Outlet Ranges	Up to 35bar (510psi)
Design Proof Pressure	150% max WP
Seat Leakage	In accordance with ANSI/FCI 70-3
Weight	1.2kg (2.4lbs)

FEATURES AND BENEFITS

1 LARGE PRECISION-MACHINED SENSING ELEMENT

Accurate control of outlet pressures up to 40bar (580psi) on non-venting models.

2 OPTIONAL BALANCED DESIGN

Enables inlet pressures of up to 414bar (6,000psi)

3 LIGHTWEIGHT & COMPACT DESIGN

Perfect for when installation space is restricted.

4 SELF-VENTING OR NON-VENTING MODELS

Versatile use for a range of applications.

NOTE: Product availability and specifications contained herein are subject to change without notice. Consult local distributor or factory for potential revisions and/or service related issues. Pressure Tech Ltd support with product selection recommendations only - it is the users responsibility to ensure the product is suitable for their specific application requirements.



DESIGNED AND BUILT IN THE UK

PRESSURE TECH LTD

Unit 24, Graphite Way, Hadfield, Glossop, Derbyshire, UK, SK13 1QH
 T +44 (0)1457 899 307
 E info@pressure-tech.com
 W www.pressure-tech.com

280717

PAGE:
1 OF 4

MF-101 Datasheet

MEDIUM-FLOW PRESSURE REGULATOR



● Gas ● Liquid |
 ● Diaphragm ● Piston |
 ● Self-Venting ● Non-Venting |
 Max Inlet: 414bar (6,000psi) |
 Max Outlet: 35bar (510psi) |
 Cv 0.5

DRAWINGS AND INSTALLATION DIMENSIONS

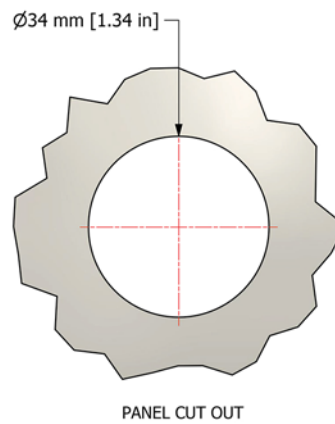
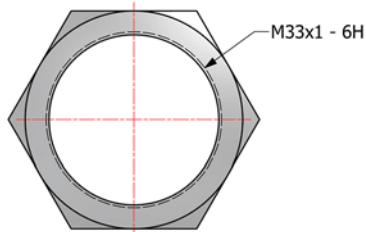
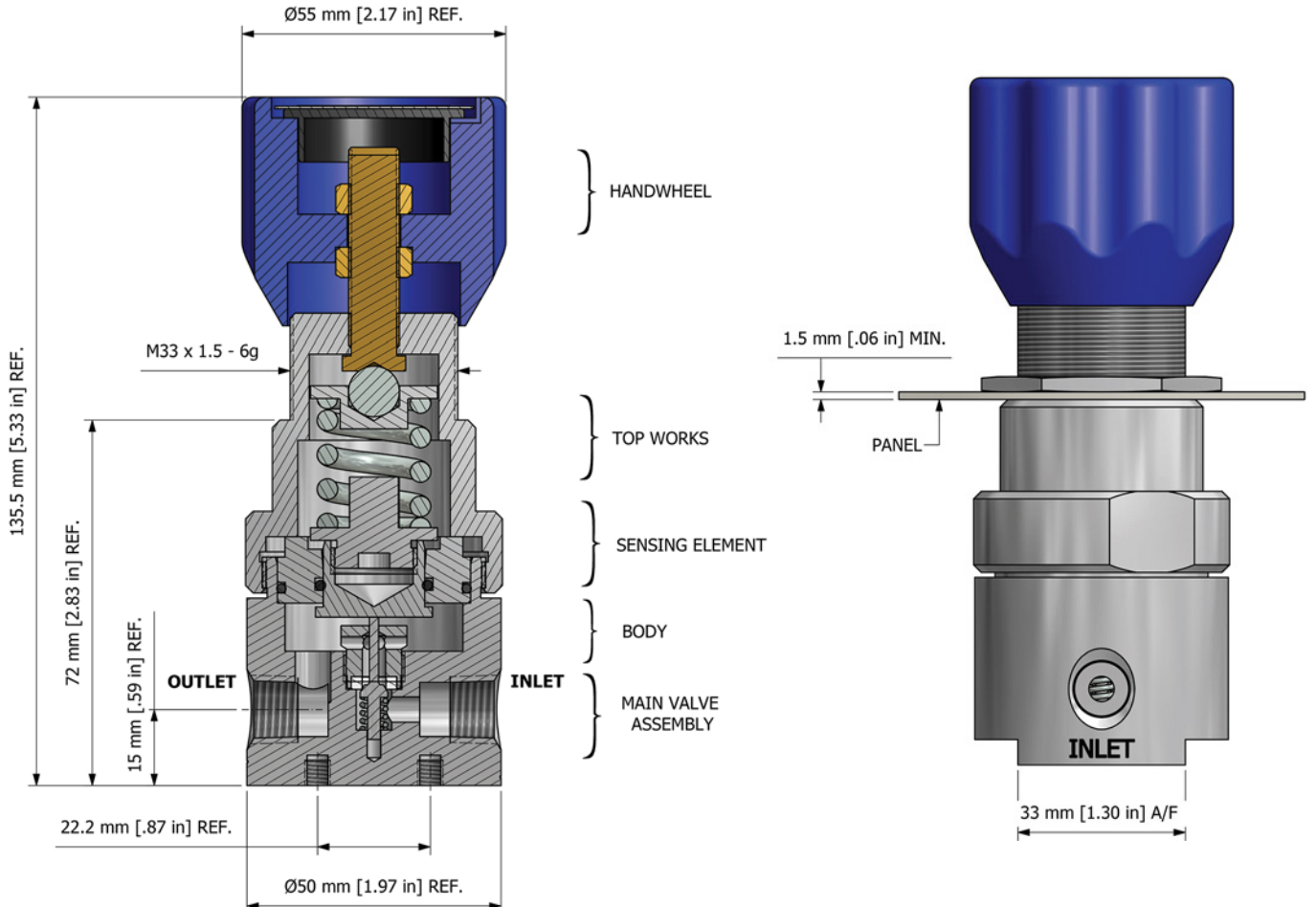

Note:
 All gauge ports are 1/4" NPT as standard.

NOTE: Product availability and specifications contained herein are subject to change without notice. Consult local distributor or factory for potential revisions and/or service related issues. Pressure Tech Ltd support with product selection recommendations only - it is the users responsibility to ensure the product is suitable for their specific application requirements.



DESIGNED AND BUILT IN THE UK

PRESSURE TECH LTD
 Unit 24, Graphite Way, Hadfield, Glossop, Derbyshire, UK, SK13 1QH
 T +44 (0)1457 899 307
 E info@pressure-tech.com
 W www.pressure-tech.com

280717

PAGE:
2 OF 4

MF-101 Datasheet

MEDIUM-FLOW PRESSURE REGULATOR



● Gas ● Liquid | ● Diaphragm ● Piston | ● Self-Venting ● Non-Venting | Max Inlet: 414bar (6,000psi) | Max Outlet: 35bar (510psi) | Cv 0.5

FLOW CURVE

Please contact the office for further information.

PORTING CONFIGURATIONS

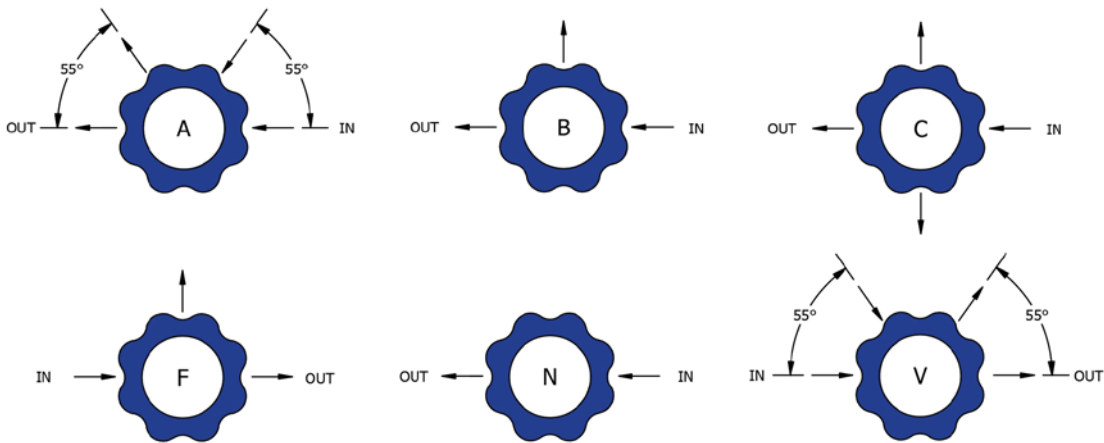

Note:

Additional porting configurations are available - please contact the office for further information.

NOTE: Product availability and specifications contained herein are subject to change without notice. Consult local distributor or factory for potential revisions and/or service related issues. Pressure Tech Ltd support with product selection recommendations only - it is the users responsibility to ensure the product is suitable for their specific application requirements.



DESIGNED AND BUILT IN THE UK

PRESSURE TECH LTD

Unit 24, Graphite Way, Hadfield, Glossop, Derbyshire, UK, SK13 1QH
T +44 (0)1457 899 307
E info@pressure-tech.com
W www.pressure-tech.com

280717

PAGE:
3 OF 4

MF-101 Datasheet

MEDIUM-FLOW PRESSURE REGULATOR



Gas
 Liquid
 Diaphragm
 Piston
 Self-Venting
 Non-Venting
 Max Inlet: 414bar (6,000psi)
 Max Outlet: 35bar (510psi)
 Cv 0.5

ORDERING INFORMATION

To build a Pressure Tech part number, simply combine the characters identified below in sequence:

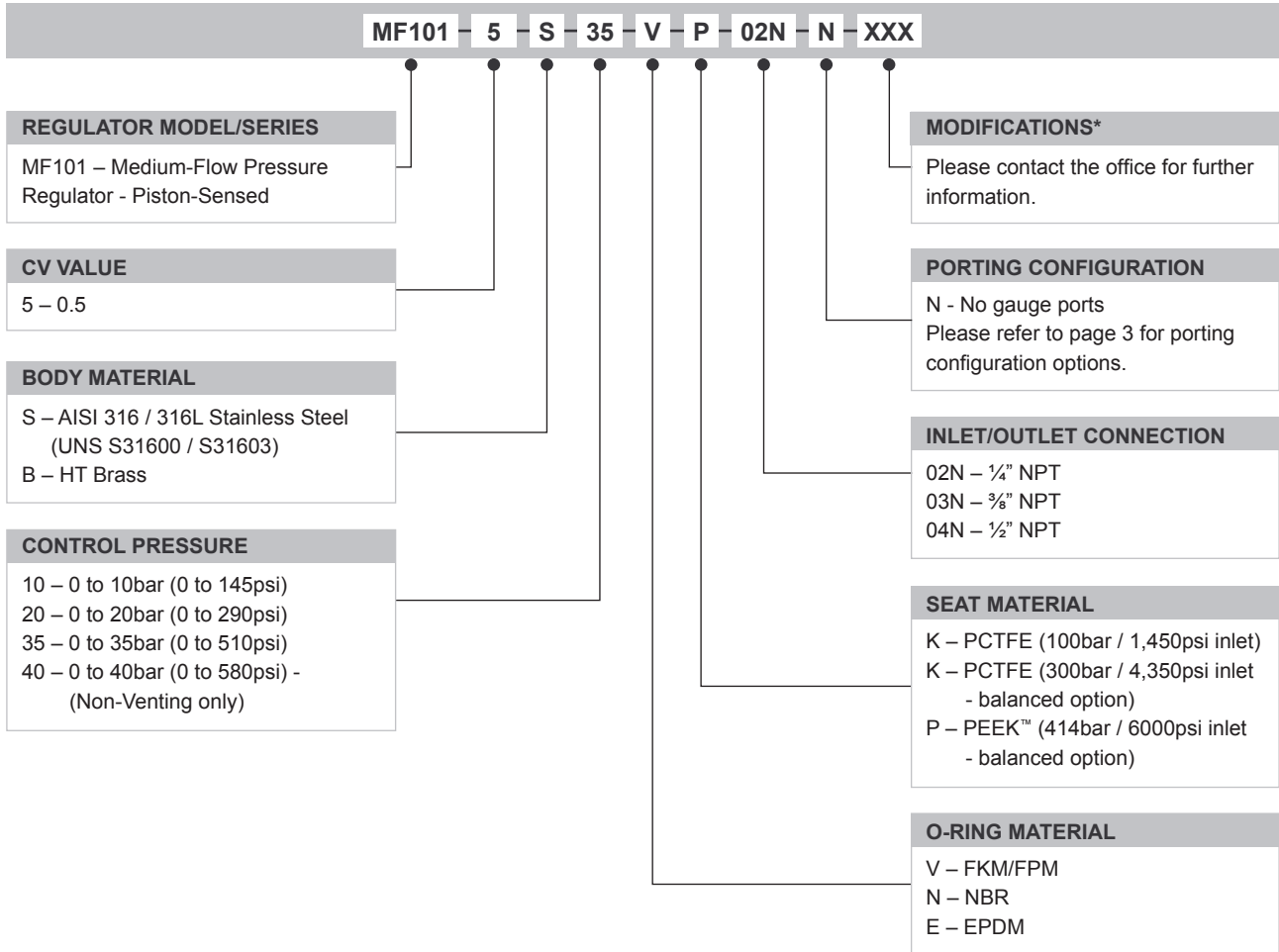

* Where applicable

OPTIONAL EXTRAS		
	PART NUMBER	DESCRIPTION
Service Kit	SRK-MF101-05-B...	Various 'Balanced' options available - contact the office for further information.
Service Kit	SRK-MF101-05-U...	Various 'Unbalanced' options available - contact the office for further information.
Panel Mount Ring	PT-C-024	-

Note:
Ancillary Equipment also available. Please contact the office for further information.

TRADEMARKS: PEEK™ is a trademark of Victrex PLC
Inconel® is a registered trademark of Inco Alloys International

NOTE: Product availability and specifications contained herein are subject to change without notice. Consult local distributor or factory for potential revisions and/or service related issues. Pressure Tech Ltd support with product selection recommendations only - it is the users responsibility to ensure the product is suitable for their specific application requirements.



DESIGNED AND BUILT IN THE UK

PRESSURE TECH LTD
Unit 24, Graphite Way, Hadfield, Glossop, Derbyshire, UK, SK13 1QH
T +44 (0)1457 899 307
E info@pressure-tech.com
W www.pressure-tech.com

280717

PAGE:
4 OF 4